



NDA/ATAA
COMPLIANT PRODUCTS

Dimensions

unit: Inch (mm)

UNIVERSAL HD COAX[™]

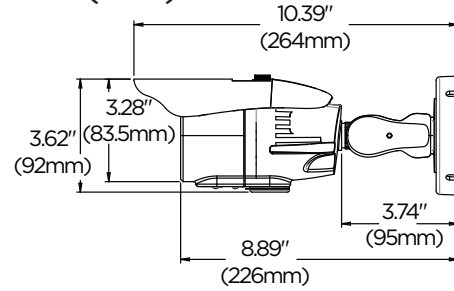

2.1 Megapixel Universal HD / Analog
 6-50mm Vari-focal P-Iris Lens
 LPR
 50mph
 5 YEAR Warranty

Summary

2.1MP/1080p LPR cameras deliver crystal-clear images and support real-time 30fps HD-Analog, HD-TVI, HD-CVI and all analog signals to 960H. The camera is engineered to capture license plates of moving vehicles in extreme light conditions, from ranges of 13 to 115 feet at up to 50mph. The IP66 rated vandal housing assures that license plates are captured clearly and visibly no matter the lighting challenge or weather condition. DW[®] LPR cameras are engineered to work with our VMAX[®] A1 Plus[™] Universal HD over Coax[®] DVRs using your existing Coax infrastructure for a cost-effective, high resolution surveillance solution.

Features

- Universal HD over Coax[®] technology with HD-Analog, HD-TVI, HD-CVI and all legacy analog signal support
- 2.1MP/1080p 1/3" image sensor at real-time 30fps
- HD Analog LPR[™] license plate recognition technology captures reflective license plates up to 50mph with a 13'-30' capture range
- Reliable performance under any lighting conditions
- External OSD and lens adjustment
- 6-50mm varifocal p-iris Lens
- OSD control via coaxial (UTC)
- 115' Smart IR[™] with intelligent camera sync.
- Smart DNR[™] 3D digital noise reduction
- Highlight masking exposure (HME)
- Auto sensing 24VAC/12VDC with line lock
- Easy icon driven OSD menu with built-in joystick
- Programmable Privacy Zones
- Auto gain control (AGC)
- Backlight compensation (BLC)
- Dynamic range compressor (DRC) reveals low light detail
- IP66 environmental-rated dust-tight and water-resistant
- 5 year warranty

Specifications

Designed and engineered in U.S.A and Korea

IMAGE	
Image sensor	2.1MP/1080p 1/3" CMOS
Active pixels	1944 (H) x 1092 (V)
Scanning system	Progressive scan
Frequency	60Hz / 50Hz
Signal technology	Universal HD over Coax [®] technology with HD-Analog, HD-TVI, HD-CVI to 1080p and all analog to 960H signal support
Synchronization	Internal
Resolution	1920 x 1080 (1080p)
Minimum scene illumination	0 lux (B/W) 55dB
Video output	HD-Analog, HD-TVI, HD-CVI 2.1MP/1080p CVBS Analog up to 960H
I/O	
Alarm output	1 alarm output
LENS	
Focal length	6 - 50mm
Lens type	Varifocal p-iris lens
Field of view (FoV)	45.3° - 5.7°
IR distance	115ft range
OPERATIONAL	
Image capture range	13'-115' and 50 MPH
Shutter mode	Auto, manual, FLC
Shutter speed	1/30-1/30,000
Backlight	On, off
Dynamic range compressor (DRC)	Off, low, middle, high
Smart DNR [™] 3D digital noise reduction	Off, low, middle, high
Day / night	Night
Mirror / flip Auto gain control	Yes
Auto gain control	0-10
Motion detection	Yes
Privacy zones	16 programmable privacy zones
Sharpness	0 - 10
Gamma	0.45 - 0.75
De-fog	On, off
RS485 / UTP built-in	Pelco D / Pelco C
ENVIRONMENTAL	
Operating temperature	-4°F - 122°F (-20°C - 50°C)
Operating humidity	10-90% RH (non-condensing)
IP rating	IP66 certified weather and tamper resistant
Other certifications	CE, FCC, RoHS
ELECTRICAL	
Power requirements	DC12V/AC24V dual voltage
Power consumption	DC12V (LED oN): 6.12W AC24V (LED oN): 5.7W
MECHANICAL	
Material	Aluminum bullet housing
Dimensions	9.4" x 3.81" (264 x 96.7mm)
Weight	1.83lbs (0.83kg)
Warranty	5 year warranty

Accessories (Optional)

